

LFDBV

旁通阀

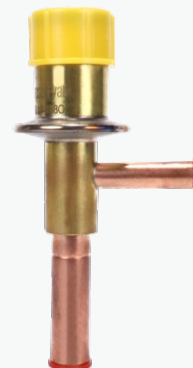
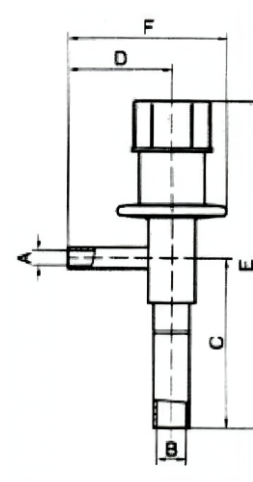

选型表

尺寸及重量

型号	编号	接口尺寸		安装尺寸			
		进口(A)	出口(B)	C	D	E	F
LFDBV	0.5	6mmODF	10mmODF	58	36	106	54
	1.0						
	2.0	1/4"ODF	3/8"ODF	64	47	122	69
	3.0						
	4.0	10mmODF	16mmODF	64	47	122	69
	5.0						
6.0	3/8"ODF	5/8"ODF	64	47	122	69	

LFDBV型旁通阀用于不具备能量卸载机构的制冷压缩机组实现系统能量调节，广泛应用于冷干机、制冰机等制冷设备。LFDBV型旁通阀可用作定压式膨胀阀，保持稳定的蒸发压力(温度)。LFDBV型旁通阀可防止制冷压缩机组的吸气压力不高于其最低极限值。LFDBV型旁通阀主要功能是在当阀的出口压力发生变化时，阀门会自动调节性地关闭或开启，保持出口压力恒定在设定值上，且不受进口压力大小（一定范围）的影响。铜管焊口连接，安全工作压力为28bar。

容量

型号	编号	通径	名义制冷量			
			R134a	R22	R404A	R507
LFDBV	0.5	0.7	0.98	1.4	1.0	1.0
	1.0	1.0	1.4	2.1	1.5	1.5
	2.0	2.0	2.9	4.2	3.0	3.0
	3.0	3.0	6.7	9.8	6.8	6.9
	4.0	3.5	8.9	12.8	9.0	9.0
	5	4.75	16.3	23.6	16.5	16.6
	6	5	20.4	30.6	21.4	21.6

LFDBV

Discharge-Bypass Valves

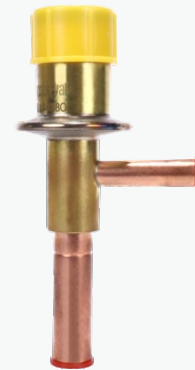
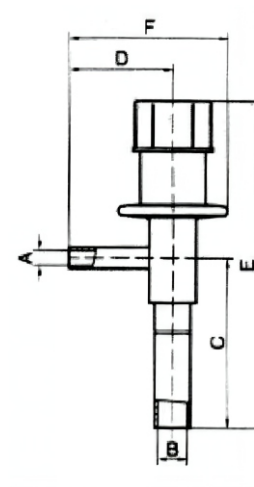

Model Selection

Dimensions and Weights

Model	valve size	Connections		Dimensions(mm)			
		Inlet(A)	Outlet(B)	C	D	E	F
LFDBV	0.5	6mmODF	10mmODF	58	36	106	54
	1.0						
	2.0	1/4"ODF	3/8"ODF	64	47	122	69
	3.0						
	4.0	10mmODF	16mmODF	64	47	122	69
	5.0						
6.0	3/8"ODF	5/8"ODF	64	47	122	69	

LFDBV discharge-bypass valve is a kind of load adjust component for the refrigerating system with a nonadjustable compressor. LFDBV discharge-bypass valve can be used as automatic expansion valve under fixed pressure to maintain the fixed evaporation pressure (temperature). LFDBV is capable of maintaining the minimum evaporating pressure. LFDBV discharge-bypass valve can automatically change the opening to get the constant outlet pressure on regardless of the change of the inlet pressure (within a certain range). ODF connecting. Maximum working pressure: 28bar.

Capacities

Type	valve size	orifice size	Nominal capacity(kw)			
			R134a	R22	R404A	R507
LFDBV	0.5	0.7	0.98	1.4	1.0	1.0
	1.0	1.0	1.4	2.1	1.5	1.5
	2.0	2.0	2.9	4.2	3.0	3.0
	3.0	3.0	6.7	9.8	6.8	6.9
	4.0	3.5	8.9	12.8	9.0	9.0
	5	4.75	16.3	23.6	16.5	16.6
	6	5	20.4	30.6	21.4	21.6